

| REVISIONS | | | | |
|-----------|---------------|------------------|-----------------------|------------|
| REV. SYM. | E.C.O. NUMBER | DESCRIPTION | BY DATE | APP'D DATE |
| 1 | | ORIGINAL RELEASE | B. CAPERS 01/28/97 | DE 1/97 |
| 2 | | .404 WAS .450 | K. KOONS 8.12.09 | |
| 3 | | CAVITY UPDATE | ENF 11.30.09 | |

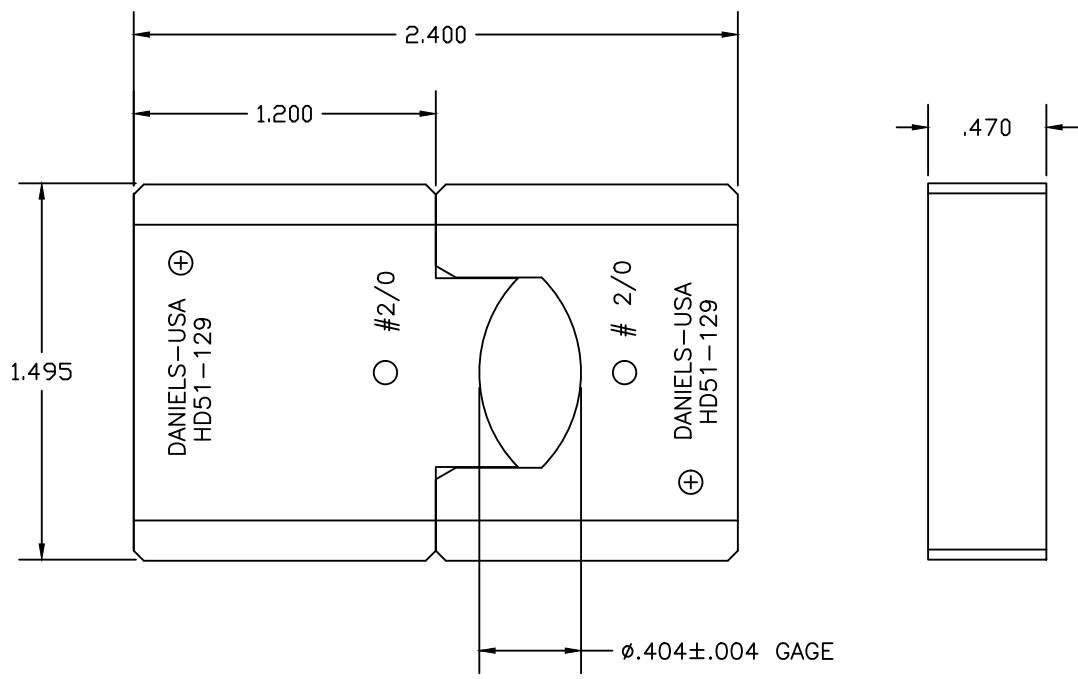

**UNCONTROLLED DOCUMENT
WILL NOT BE UPDATED**

1. USED FOR SIZE #2/0 INSULATED TERMINALS.

NOTES:

| | | | | | | | | |
|---|--|-------------|--|--------------------------------|-----------|-------------------------------------|---|---------|
| RESTRICTED & CONFIDENTIAL | | MATERIAL | | ITEM | PART NO. | QTY. | DESCRIPTION/REMARKS | |
| CONFIDENTIAL PROPERTY OF DANIELS MANUFACTURING CORP. NOT TO BE DISCLOSED TO OTHERS. REPRODUCED OR USED FOR ANY OTHER PURPOSE, EXCEPT AS AUTHORIZED IN WRITING BY DANIELS MANUFACTURING. MUST BE RETURNED TO DANIELS MANUFACTURING CORP. ON COMPLETION OF ORDER OR OTHER PURPOSE FOR WHICH LENT. | | HEAT TREAT | | DRN. | B. CAPERS | DATE | DANIELS MANUFACTURING CORP. ORLANDO, FLORIDA CAGE 11851 | |
| | | | | CHK'D. | DE | DATE | | |
| | | | | APP'D. | | DATE | | |
| | | | | APP'D. | | DATE | | |
| DO NOT SCALE DRAWING | | FINISH | | TOLERANCE: | | TITLE | | |
| | | | | UNLESS OTHERWISE SPECIFIED | | DIE SET ENVELOPE DRAWING | | |
| | | | | FRACTIONS: ±1/32 ANGLES: ±1/2° | | | | |
| | | | | DECIMAL INCHES: | | | | |
| | | WHERE USED: | | SIZE | SCALE | | | CAD P/N |
| | | | | B | 2X | HD51-129-ENV | 1 | 1 |
| | | | | POSTING | | P/N | | REV. |
| | | | | | | HD51-129-ENV | | 3 |